



GVN11 PRO

Home Lift

GiantKONE Elevator Co., Ltd.

2005 Xunzhi Rd. Nanxun Economic Development Zone,
Huzhou, Zhejiang, P.R.China
P.C. 313009
Tel.: +86-572-3017777
Mobile: +86 181 0582 5368
Mail: gke@giantkone.com

8A88 Shanghai Mart, 2299 Yan An Rd(W)
Shanghai P.R.China
P.C. 200336
Tel.: +86-572-3017777
Mobile: +86 181 0582 5368
Mail: gke@giantkone.com





GKE is a strategic brand of GiantKONE Elevator Co. Ltd. in overseas market. GiantKONE, founded in 2005, is a leading Elevator & Escalator solution provider in China market.

As a key member of a highly acclaimed international enterprise, our mission is to make urban life better with products and services of excellent affordability, outstanding technology, and remarkable reliability over the full life cycle.

GKE home lift is a machine-roomless home elevator developed to meet the needs of middle and high-end villas/townhouses/duplex apartments.

Adhering to the concept of safety, technology and humanity, GKE brings convenience and comfort to every family, the convenience we can provide to you will highlight your honor and enhance the value.

Specifications

Speed (m/s)	Load Capacity (kg)	Maximum Travel (m)	Maximum Number of Landings
0.4/0.63/1.0	250/320/400	18	6

FEATURES & ADVANTAGES

- SPACE FREEDOM**

GKE home lifts are designed with safety as a core principle. They are equipped with a power failure automatic rescue device and a one-key call alarm function, which provide users with the highest level of protection.
- GREEN AND ENVIRONMENT-FRIENDLY**

The single-phase 220V power supply reduces the application barrier.

The daily energy consumption of a home elevator is less than that of a refrigerator.
- COMFORTABLE RIDE**

GKE home lift features a permanent magnet synchronous gearless traction machine, which effectively reduces noise pollution. Its advanced vector conversion technology allows for real-time speed adjustments based on human comfort requirements, ensuring a safe and comfortable ride.
- DEXTEROUS LAYOUT**

Machine room-less design, low overhead solution requires only 2750mm overhead and 400mm pit depth, while the low pit solution requires only 2850mm overhead and 200mm pit depth. These specifications effectively improve the utilization rate of the building and provide more creative space for designers.

Power Failure Automatic Rescue Device



- In the event of an emergency power failure, the emergency lighting in the car is switched on and the lift switches to the back-up power source.



- The lift will automatically travel to the nearest floor, open the door and release passengers for automatic rescue.





- The lift will return to normal when power is back on.



One-touch Call Alarm

Push the button to call your mobile phone / property directly

 Family

 Property

 Friend

*Safety Escort
Peace of Mind
on Every Journey*

ALUMINUM
ALLOY FOR
SCENIC
ELEVATOR
STYLISH
DESIGN AND
EASY TO
INSTALL



Different colors for option

Champagne

Phantom Black

Pearl White

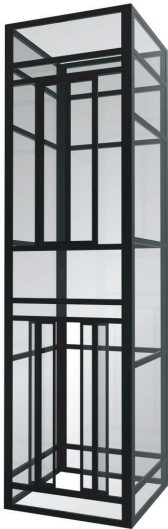



CAR RECOMMENDATION

Low Headroom

◀ Mixed Car

Ceiling : G1025052(304 Stainless steel cladding • Linear light)
Car wall : 304 Hairline stainless steel
Floor : 51950073 (PVC)
COP : 016



GKE



Nordic Style ▶

G1025054 : Ceiling
(304 Stainless steel cladding • Downlight)
Hairline stainless steel • Wood grain steel plate : Car wall
51950074(PVC) : Floor
016 : COP

Optinal color

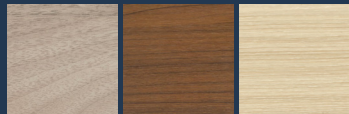

Oak (Wood-veneer plate) Maple (wood-veneer plate) Walnut (wood-veneer plate)



GKE



CAR RECOMMENDATION

Low Pit Depth

◀ Waterwood Era

Ceiling : Aluminum frame • Acrylic
Front wall : Black satin DPM steel sheet
Car door : Black satin DPM steel plate
Sidewall : Wood grain DPM steel plate • Black satin grain DPM steel plate
Rear wall : Wood grain DPM steel plate • Wood grille • Lighting tape
Floor : 52031399(PVC)
COP : 016



GKE



Glided Moment ▶

Champagne ripple stainless steel : Ceiling
+ Lighting tape
Champagne steel plate : Front wall
Champagne steel plate : Car door
Champagne mirror stainless steel : Sidewall
+ Champagne steel plate
Champagne steel plate, Stone : Rear wall
patterned steel plate + Light strip
52031399(PVC) : Floor
016 Champagne swing operator : COP



GKE

SIGNALIZATION
FOR SCENIC CAR // SWING COP /

ELEGANT SIGNALIZATION



/ LOP /



/ COP & LOP display /



/ CEILING /

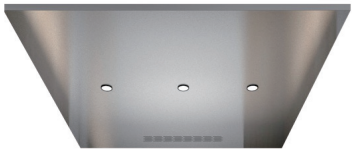

G1025054
stainless steel 304, LED light



G1025053
Aluminum Frame Acrylic panel



G1025052
Stainless steel 304, LED light

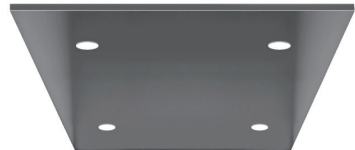

G1025057
Mirrow stainless steel, LED light

/ FLOOR /

PVC ►



51950073



51950074

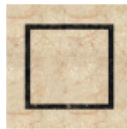

G4083001



51782380

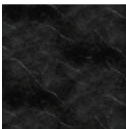

51782381

Marble ►

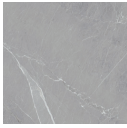

51781628



G4003015



G4003014



G4003013

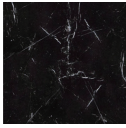

51781629

CEILING & FLOOR

ELEVATOR FUNCTION TABLE

		● Standard
		○ Optional
SECURITY FUNCTIONS		
Rescue and fault monitoring		
COD	Fix the run	●
DTS	Runtime detection	●
BMV R	Resistor braking	●
RDF RC	Emergency electric operation	●
LBI	Brake release device	●
Emergency backup power and power restoration operations		
LPS TN	Synchronous run	●
CEL S	Emergency car lighting	●
EBS S	Emergency battery powered	●
PEL	Power outage emergency leveling	●
Emergency communications		
IF	Intercom function	●
Other safety functions and maintenance		
SWD	Maintenance operation	●
BOF	Door open and close button for maintenance	●
CDC	Car door contact	●
CDL O	Car door limit switch	●
DOP	No door allowed	●
EMH	Pit emergency stop switch	●
EMR	Car roof emergency stop switch	●
LCD	Disable LOP function	●
OSG CM	Car speed limiter safety switch	●
SGE	safety gear safety switch	●
TWC	Speed limiter tightening safety switch	●
ASC	Elevator upward overspeed protection	●
DCD	Door lock circuit detection	●
ISM	Overhauling safety mechanical blocking devices	●
IST	Repair safety pin	●
CLF C	Car lighting main switch - Control cabinet	●
MAS C	Elevator main switch- Control cabinet	●

PASSENGER COMFORT FUNCTIONS

Entering and exiting the car		
DCB	Door close button	●
DOB	Door open button	●
QCC	Cop opens the door quickly	●
REO O	LOP reopens	●
SRC RNC	Single light curtain	●
Abuse, misuse protection		
SPB BP	Button adhesion monitoring	●
FCC R	Press twice to cancel the COP button command	●
CCB	Reverse COP call	●
Running comfort		
VVVF E	Elevator variable frequency drive	●
OCL A	Car lighting automatic control	●
OCV A	Car ventilation automatic control	●

CONTROL FUNCTIONS

Idle car allocation		
PAM	Automatically return to base station	●

INFORMATION FUNCTIONS

Information display outside the hall		
LCL	LOP registration indicator light	●
Information display in the car		
OLF C	Car overload function	●
CCL	COP registration indicator light	●
ACU F	Voice station announcement	○
Information display in the control cabinet		
CPI PS	Car position display	●
SCN N	Start counter	●
CIL A	Labels on components inside the control cabinet	●
DZI N	Door area instructions	●

SPECIFICATIONS

Car height (mm)	Door height (mm)	Overhead (mm)	Pit depth (mm)
2100	2000	2750	400
2200	2100	2850	
2300	2200	2950	

Minimum pit depth can be 300mm, please consult GKE Sales team. Different ceiling may influence overhead.

Load Capacity (kg)	Door type	Car dimensions (mm)	Door net width (mm)	Doorway width (mm)	Minimum shaft dimensions (mm)	Shaft type
4/320	Side opening	900×1100	700	900	1400×1450	Concrete
4/320	central opening	900×1100	700	900	1550×1400	
5/400	Side opening	1100×1100	800	1000	1600×1450	
5/400	central opening	1100×1100	800	1000	1750×1400	

Low pit Solution

Car height (mm)	Door height (mm)	Overhead (mm)	Pit depth (mm)
2100	2000	2850	200
2200	2100	2950	
2300	2200	3050	

Minimum pit depth can be 150mm, please consult GKE Sales team. Different ceiling may influence overhead.

Load Capacity (kg)	Door type	Car dimensions (mm)	Door net width (mm)	Doorway width (mm)	Minimum shaft dimensions (mm)	Shaft type
4/320	Side opening	900×1100	800	1000	1410×1440	Concrete
4/320	central opening	900×1100	700	900	1550×1350	
5/400	Side opening	1100×1100	900	1100	1610×1440	
5/400	central opening	1100×1100	800	1000	1750×1350	

Load Capacity (kg)	Door type	Car dimensions (mm)	Door net width (mm)	Doorway width (mm)	Minimum shaft dimensions (mm)	Reserved shaft dimensions (mm)	Shaft type
4/320	Side opening	900×1100	750	750	1400×1440	1410×1440	Aluminum
4/320	central opening	900×1100	700	700	1550×1350	1550×1350	
5/400	Side opening	1100×1100	900	900	1600×1440	1610×1440	
5/400	central opening	1100×1100	800	800	1750×1350	1750×1350	

CONSTRUCTION SKETCH

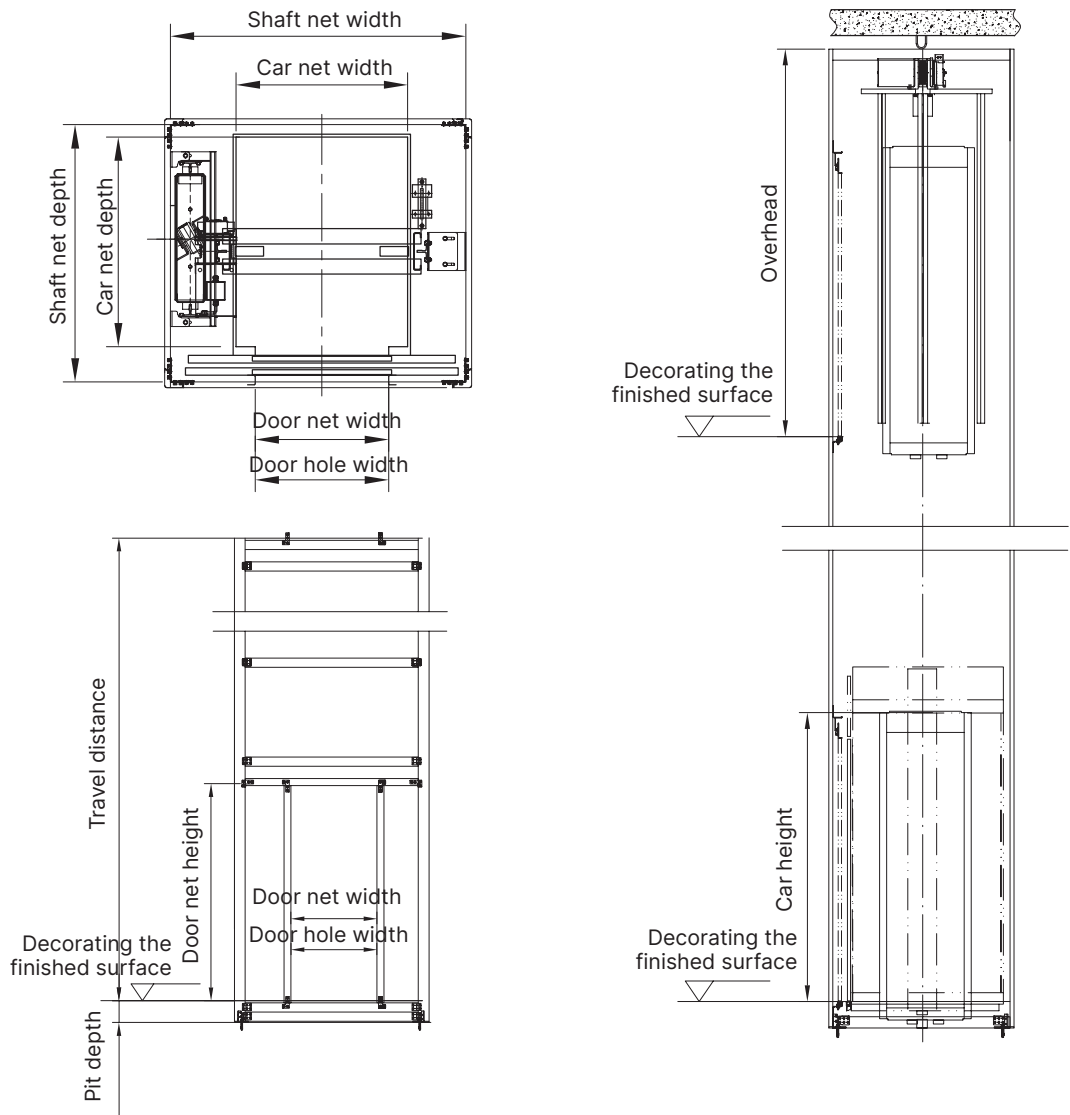

Two panels, Central opening (Scenic shaft)

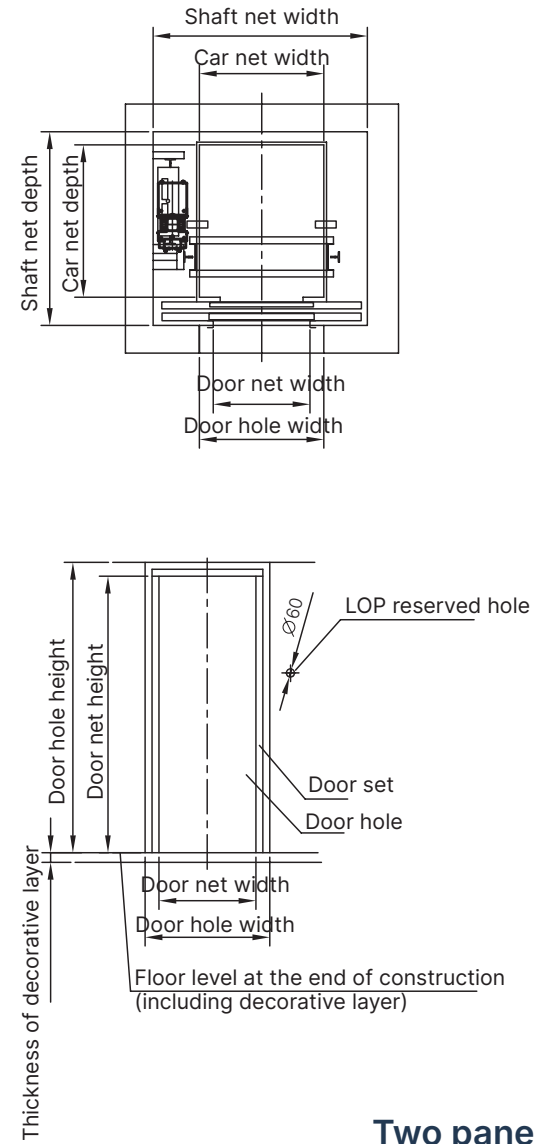

Two panels, Central opening

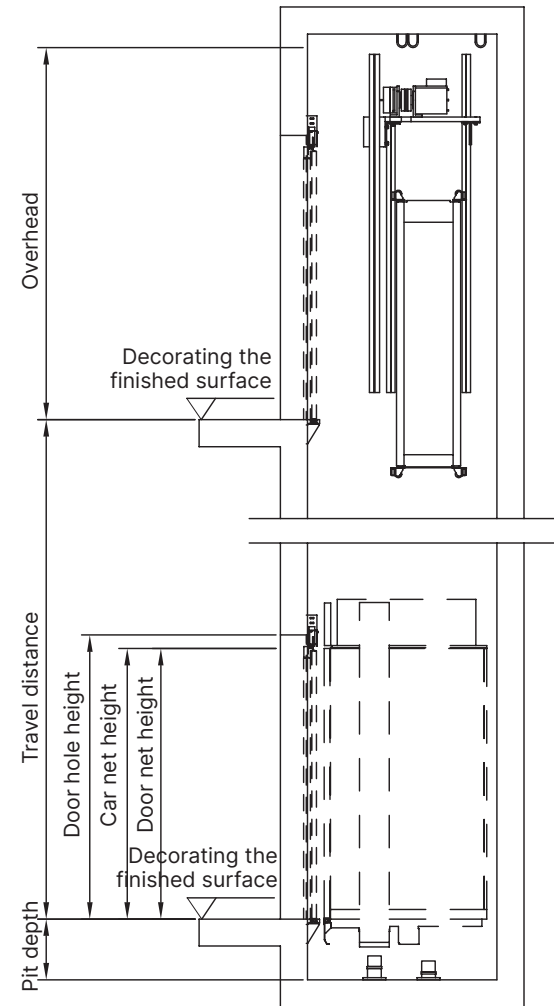

CONSTRUCTION SKETCH

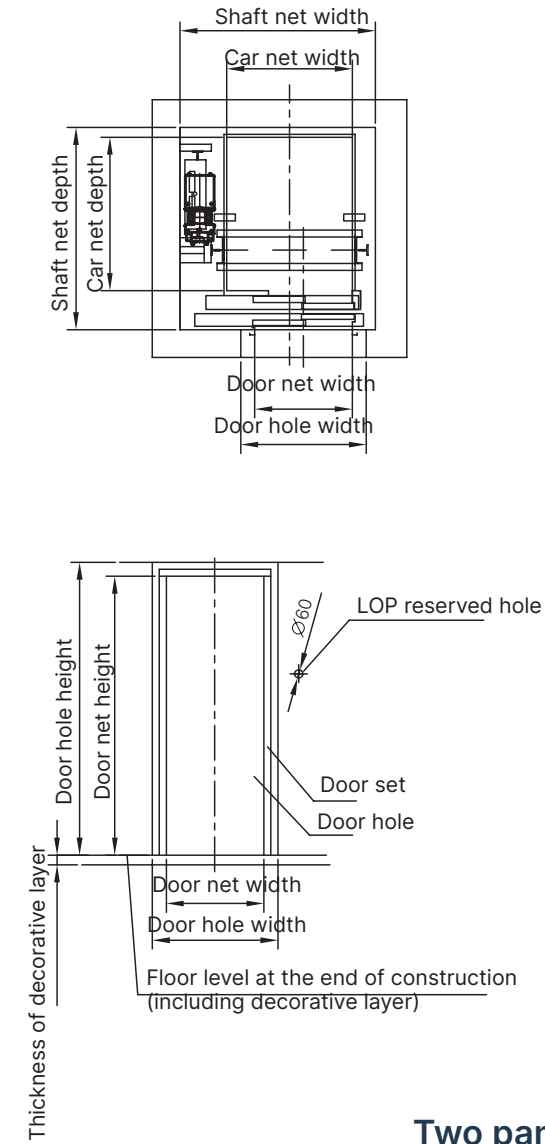

Two panels, Side opening

